

TRACKER LITHIUM 12v 6Ah

CB-LFP1260

Advantages of LFP Over SLA

- Lower cost per cycle, greater than ten times the cycle life of sealed lead-acid batteries
- Ultra-light weight; Significantly lighter than sealed lead-acid batteries
- Drop in replacement for sealed lead-acid batteries
- Can use the same charger as sealed lead-acid batteries in most cases (limited to a voltage of 14.6 volts)
- Faster charging as a result of higher charge current
- More usable capacity - sealed lead-acid battery capacity decreases as discharge current increases
- Includes Battery Management System (BMS) protection. Contains a circuit that fully protects itself with a Low Voltage Disconnect and a High Current Disconnect on discharge
- Balancing circuit on charge



7 Ah Size Case

Due to continuous improvements to our products, product may vary slightly from depiction.

Specifications:

Nominal Voltage	12.8 Volts		
Nominal Capacity	77° F (25° C)		
20-hr. (.30 A)	6 Ah		
10-hr. (.60 A)	6 Ah		
5-hr. (1.2 A)	6 Ah		
2-hr. (2.85 A)	5.7 Ah		
Approximate Weight	1.80 lbs (0.821 kgs)		
Internal Resistance (approx.)	≤65mΩ		
Shelf Life (% of normal capacity at 68° F (20° C))			
3 Months	6 Months	12 Months	
97%	95%	85%	
Temperature Dependency of Capacity			
-10°C	-0°C	25°C	55°C
50%	65%	100%	95%

Battery Certifications	UN38.3
LFP Operational Temperature	
Charge	32 F° to 113 F° (0°C to 45°C)
Discharge	-4° F to 140° F (-20°C to 60°C)
LFP Storage Temperature	14° F to 95° F (-10°C to 35°C)
Charge Method (Constant Voltage)	
Cycle Use (Repeating Use)	
Initial Current	3 A or smaller
Control Voltage	14.6 V
Float Use	
Control Voltage	13.8 V

Physical Dimensions: in (mm) Terminals:

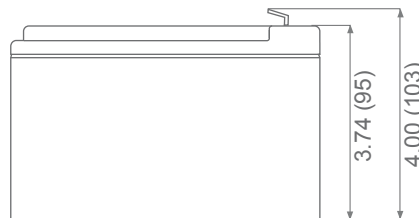
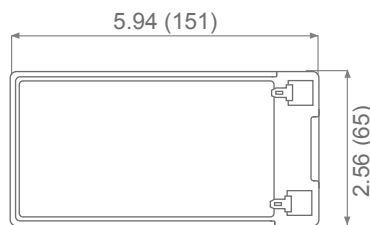

L: 5.94 in (151mm)
W: 2.56 in (65 mm)
H: 3.74 in (95 mm)
TH: 4.00 in (103 mm)
 Tolerances are +/- 0.04 in. (+/- 1mm) and +/- 0.08 in. (+/- 2mm) for height dimensions. All data subject to change without notice.

F Series (Faston Tabs)

Dimension Type	L	W	w	T
F2	7.9 mm 0.31 in	6.4 mm 0.25 in	8.2 mm 0.32 in	.8 mm 0.03 in

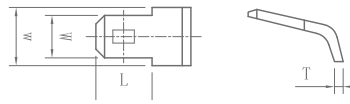

TRACKER LITHIUM 12v 12Ah

CB-LFP12120

Advantages of LFP Over SLA

- Lower cost per cycle, greater than ten times the cycle life of sealed lead-acid batteries
- Ultra-light weight; Significantly lighter than sealed lead-acid batteries
- Drop in replacement for sealed lead-acid batteries
- Can use the same charger as sealed lead-acid batteries in most cases (limited to a voltage of 14.6 volts)
- Faster charging as a result of higher charge current
- More usable capacity - sealed lead-acid battery capacity decreases as discharge current increases
- Includes Battery Management System (BMS) protection. Contains a circuit that fully protects itself with a Low Voltage Disconnect and a High Current Disconnect on discharge
- Balancing circuit on charge



9 Ah Size Case

Due to continuous improvements to our products, product may vary slightly from depiction.

Specifications:

Nominal Voltage	12.8 Volts		
Nominal Capacity	77° F (25° C)		
20-hr. (.60 A)	12.0 Ah		
10-hr. (1.2 A)	12.0 Ah		
5-hr. (4.0 A)	12 Ah		
2-hr. (5.7 A)	11.4 Ah		
Approximate Weight	2.7lbs (1.23 kgs)		
Internal Resistance (approx.)	≤100mΩ		
Shelf Life (% of normal capacity at 68° F (20° C))			
3 Months	6 Months	12 Months	
97%	95%	85%	
Temperature Dependency of Capacity			
-10°C	-0°C	25°C	55°C
50%	65%	100%	95%

Battery Certifications	UN38.3
LFP Operational Temperature	
Charge	32 F° to 113 F° (0°C to 45°C)
Discharge	-4° F to 140° F (-20°C to 60°C)
LFP Storage Temperature	14° F to 95° F (-10°C to 35°C)
Charge Method (Constant Voltage)	
Cycle Use (Repeating Use)	
Initial Current	6 A or smaller
Control Voltage	14.6 V
Float Use	
Control Voltage	13.8 V

Physical Dimensions: in (mm) Terminals:

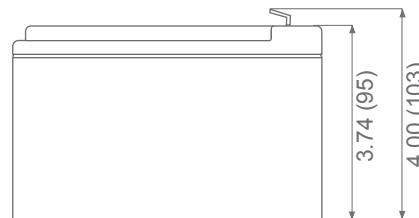
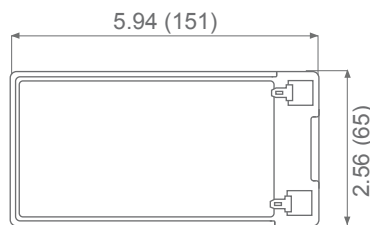

L: 5.94 in (151mm)
W: 2.56 in (65 mm)
H: 3.74 in (95 mm)
TH: 4.00 in (103 mm)
 Tolerances are +/- 0.04 in. (+/- 1mm) and +/- 0.08 in. (+/- 2mm) for height dimensions. All data subject to change without notice.

F Series (Faston Tabs)

Dimension Type	L	W	w	T
F2	7.9 mm 0.31 in	6.4 mm 0.25 in	8.2 mm 0.32 in	.8 mm 0.03 in

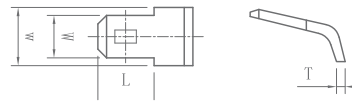

TRACKER LITHIUM 12v 18Ah

CB-LFP12180

Advantages of LFP Over SLA

- Lower cost per cycle, greater than ten times the cycle life of sealed lead-acid batteries
- Ultra-light weight; Significantly lighter than sealed lead-acid batteries
- Drop in replacement for sealed lead-acid batteries
- Can use the same charger as sealed lead-acid batteries in most cases (limited to a voltage of 14.6 volts)
- Faster charging as a result of higher charge current
- More usable capacity - sealed lead-acid battery capacity decreases as discharge current increases
- Includes Battery Management System (BMS) protection. Contains a circuit that fully protects itself with a Low Voltage Disconnect and a High Current Disconnect on discharge
- Balancing circuit on charge



9 Ah Size Case

Due to continuous improvements to our products, product may vary slightly from depiction.

Specifications:

Nominal Voltage	12.8 Volts		
Nominal Capacity	77° F (25° C)		
20-hr. (.90 A)	18.0 Ah		
10-hr. (1.8 A)	18.0 Ah		
5-hr. (3.6 A)	18 Ah		
2-hr. (8.5 A)	17.1 Ah		
Approximate Weight	4.0 lbs (1.83 kgs)		
Internal Resistance (approx.)	≤45m Ω		
Shelf Life (% of normal capacity at 68° F (20° C)			
3 Months	6 Months	12 Months	
97%	95%	85%	
Temperature Dependency of Capacity			
-10°C	-0°C	25°C	55°C
50%	65%	100%	95%

Battery Certifications	UN38.3
LFP Operational Temperature	
Charge	32 F° to 113 F° (0°C to 45°C)
Discharge	-4° F to 140° F (-20°C to 60°C)
LFP Storage Temperature	14° F to 95° F (-10°C to 35°C)
Charge Method (Constant Voltage)	
Cycle Use (Repeating Use)	
Initial Current	9 A or smaller
Control Voltage	14.6 V
Float Use	
Control Voltage	13.8 V

Physical Dimensions: in (mm) Terminals:

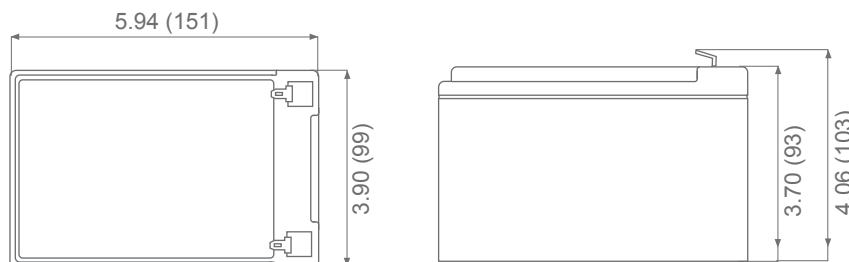

L: 5.94 in (151mm)
W: 3.90 in (99 mm)
H: 3.70 in (93 mm)
TH: 4.06 in (103 mm)

Tolerances are +/- 0.04 in. (+/- 1mm) and +/- 0.08 in. (+/- 2mm) for height dimensions. All data subject to change without notice.

F Series (Faston Tabs)

Dimension Type	L	W	w	T
F2	7.9 mm 0.31 in	6.4 mm 0.25 in	8.2 mm 0.32 in	.8 mm 0.03 in

